

ACCESS **B4** & **B4^{XL}**

Hydraulic lift with high safety features and adaptable to all pool surfaces.



Fixed with an anchor
attached to the swimming pool.



Adaptable to all types of pools, including non-overflowing ones.



Adjustable according to the depth of the pool.
Suitable for shallower pools.



Easy installation, it only requires three stainless steel plugs and three simple supports.

TECHNICAL DATA

	B4	B4XL
Max. lifting capacity:	150 Kg	
Turning angle:	160 °	
Required pressure:	3,5 a 5 bars	
Anchor arm:	355	655 mm
Minimum depth:	800 mm	
Weight:	43 Kg	44,5 Kg
Dimensions:	2425 x 700 mm	



TECHNICAL DRAWING

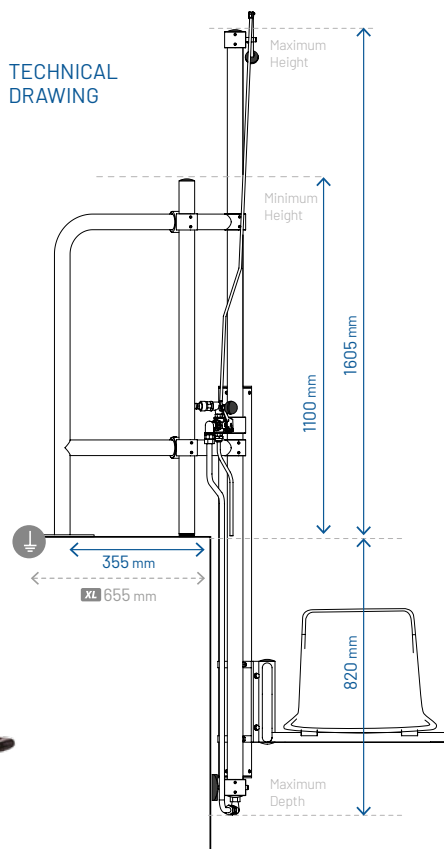

View video

ACCESS
by **BLAUTECH**

SWIMMING POOL ACCESSIBILITY EXPERTS

www.accessiblepool.com

(+34) 93 595 18 36 | access@blautec.com



ACCESS B4 & B4^{XL}

*Fixed adjustable
hydraulic lift, with low
maintenance.*

TECHNICAL ADVANTAGES



Equipment recommended for seasonal pools.



User friendly access. Water-facing transfer with rigid footrest for greater comfort and safety of the user.



Maximum autonomy for people with reduced mobility. Double operation system activated from the inside and the outside of the swimming pool.



Own manufacture in our workshop in Barcelona with stainless steel AISI 316L and polypropylene.



Minimal maintenance with maximum durability guarantees.



Technical assistance and permanent stock of spare parts.

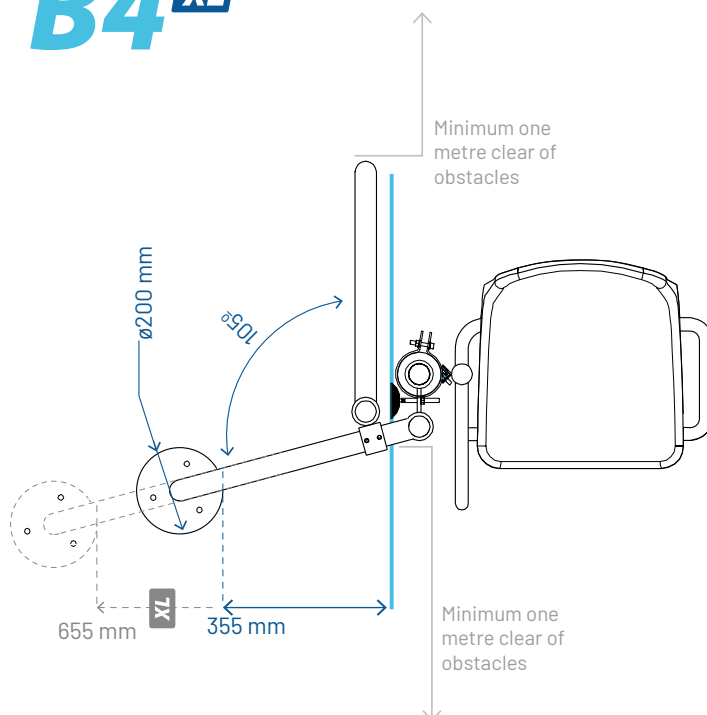

ASSEMBLY INSTRUCTIONS

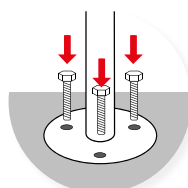

Present the lift, mark and drill the three holes.
Ø 12-12,5 mm

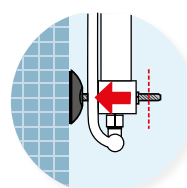

Fit the lift and the earthing terminal. Adjust the lower stop.

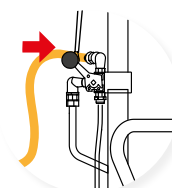

Fit the water connection to supply the circuit.

DECLARATION OF CONFORMITY

We declare under our responsibility that the machine:

Type: Hydraulic lift for people with reduced mobility

Brand: ACCESS

Is in conformity with the essential health and safety requirements of the Directives: 98/37 CE "Máquinas" And is in conformity with harmonised European standards:

UNE EN ISO 12100-1
UNE EN 982
UNE EN 1050

UNE EN ISO 12100-2
UNE EN 418
UNE EN ISO 10535

